

MyBabiie®

For little people who dream big

Group 0+/1 Orbit Car Seat (0-18kg) Instructions

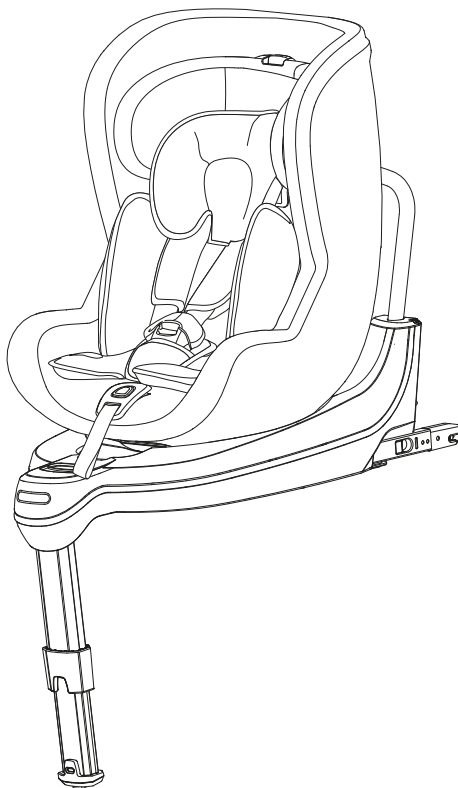

The product has been approved according to the strictest European safety standards (ECE R 44/04) and is suitable for Group 0+/1 (0-18KG).

IMPORTANT! KEEP FOR FUTURE REFERENCE

Contents

1	Important	3
2	Know your car seat	5
3	Suitability	6
4	Use in the vehicle	6
5	Installation in the vehicle	9
6	Securing your child	11
7	Cleaning	15
8	Checklist	15
9	Warranty	16

1 Important

WARNING

Read this instruction manual carefully.

- The correct fitting of the ISOFIX and support leg anchoring systems is of vital importance for the safety of your child.
 - For the future use of the seat, it is important that you keep the instruction manual carefully.
 - There is a pocket on the side of the base where the instruction can be retained with the child restraint.
 - Never leave your child unattended in the car.
 - Do not use a child safety seat if the vehicle seat is equipped with a front airbags. This can be dangerous. This does not apply to side airbags.
-
- Before using our product, please read the instruction manual carefully, the product is a safety product and is only safe when used in accordance with the instruction manual.
 - The product may be used on either the front or the back seat. However, we recommend that it is fitted on the back seat. If installed in front seat, airbag must be turned off in the vehicle
 - The product has been approved according to the strictest European safety standards (ECE R44) and is suitable for Rearward facing (0-18kg), Forward facing (9-18kg) with the ISOFIX and support leg anchoring systems.
 - After an accident the seat may become unsafe due to damage that is not be noticeable immediately. It should therefore be replaced. The safety of the seat can only be guaranteed by the manufacturer if it is used by the original owner.
 - We advise you strongly not to use a second-hand product, because you are not sure if it is in good condition. The harness pads are important for the safety of your child, therefore use them at all times.
 - Ensure that all luggage and objects likely to cause injury in the event of an accident are properly secured.
 - It is recommended that the car seats should not be used more than 5 years from the date of production. The properties of the products may deteriorate due to, for example, ageing of the plastic and this may not be visible.
 - The moving parts of the car seat should not be lubricated in anyway.
 - The baby car seat must not be used without the cover fabrics. Please use an original cover fabrics, as the cover fabric contributes to the safety of the seat.
 - **WARNING** - Do not install the car seat if there is a storage compartment below the support leg.

To see a full car compatibility list please visit www.mybabiie.com/carseats

1 Important

- The seat must be secured with ISOFIX and support leg, even when it not on use. An unsecured seat may injure other passengers in the car in an urgent stop.
- The rigid items and plastic parts of a child restraint must be so located and installed that they are not liable, during everyday use of the vehicle, to become trapped by a movable seat or in a door of the vehicle.
- Ensure that the seat is not damaged by heavy luggage, adjustable seats or slamming the car door etc.
- No alterations may be made to the product as this could affect part or the overall safety of the seat.
- In hot weather the plastic and metal parts of the product will be hot. You should cover the seat when the car parked under the sun.
- In order to prevent damage to the cover, do not remove the product's logo.
- Before the purchase, please check that the seat is properly secured in your vehicle.
- Take a short break in long journey. So that your child has some time for the relaxation.
- Set a good example yourself and always wear your seat belt.
- Tell your child that he/she should be never play with the harness buckle.

2 Know your car seat

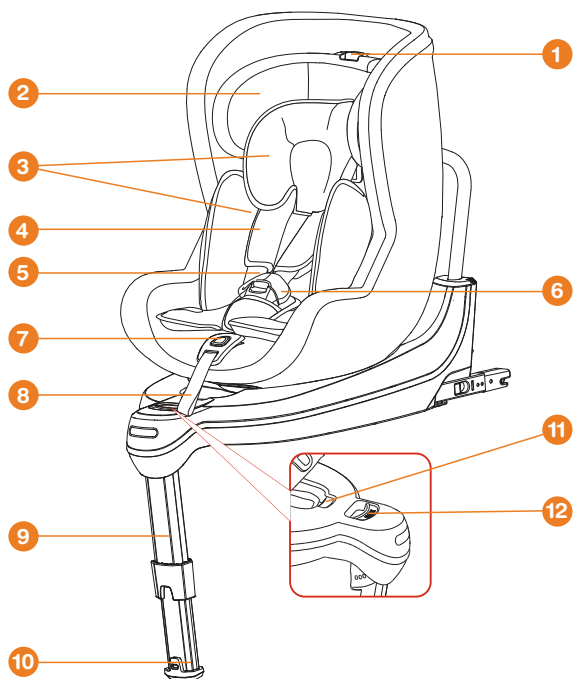

- 1. Headrest adjust button
- 2. Headrest
- 3. Insert cushion
- 4. Shoulder pad
- 5. Shoulder straps
- 6. Harness buckle
- 7. Adjusting button
- 8. Adjustment strap
- 9. Support leg
- 10. Support leg indicator

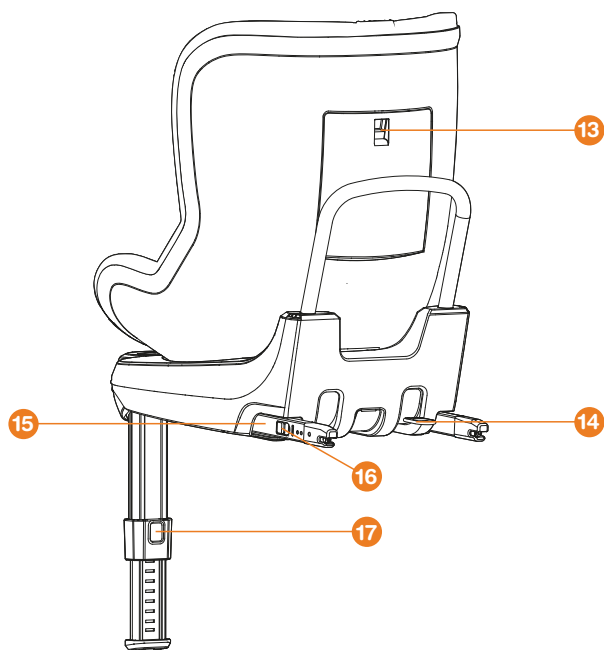

- 11. Rotating button
- 12. Isofix button
- 13. Storage compartment
- 14. Isofix retract loop
- 15. Isofix connector
- 16. Release button
- 17. Adjustment button

3 Suitability



Suitability as a child safety seat installed in a vehicle

My Babiie MBCS360 Child Safety Seat	Tested and certified according to ECE* R 44/04	
	Group	Body Weight
MBCS360	0+/I	0-18 kg

* ECE = European Standard for
Safety Equipment

The child safety seat has been designed, tested and certified according to the requirements of the European Standard for Child Safety Equipment (ECE R44/04).

The seal of approval E (in a circle) and the approval number are located on the approval label (sticker on the child safety seat).

This approval will be invalidated if you make any modifications to the child safety seat. Only the manufacturer is permitted to make modifications to the child safety seat.

4 Use in the Vehicle

Important Safety Information

This child restraint is classified for “(Semi-universal)” use and is suitable for fixing into the seat positions of the following cars:

Seat positions in other cars may also be suitable to accept this child restraint.

If in doubt, consult either the child restraint manufacturer or the retailer.

CAR CAR LIST	FRONT	REAR	
		Outer	Centre
	NO	YES	NO

- 1.This is an ISOFIX CHILD RESTRAINT SYSTEM. It is approved to Regulation No. 44, 04 series of amendments for general use in vehicles fitted with ISOFIX anchorages systems.
- 2.It will fit vehicles with positions approved as ISOFIX positions (as detailed in the vehicle handbook), depending on the category of the child seat and of the fixture.
- 3.The mass group and the ISOFIX size class for which this device is intended is:D,B1.

4 Use in the Vehicle

You can use your child car seat as follows:



Passenger seat may be on opposite side depending on country legislation/law.

In the direction of travel	YES
Against the direction of travel	NO
With 2-point belt	NO
With 3-point belt	NO
With the ISOFIX and Support Leg	YES
On front passenger seat	¹ YES
ONLY IF THERE IS NO AIRBAG OR IT IS TURNED OFF	
On outer rear seat	YES
On centre rear seat	² YES
Can be used if the vehicle seat is equipped with a ISOFIX	

(Please observe the regulations applicable to your particular country)

4 Use in the Vehicle

Securing your baby using the baby insert

! CAUTION

Never use this child restraint system in seating positions where an active frontal airbag is installed.

An active frontal airbag may cause death or seriously injury of your child in an accident.

Please read the instructions carefully and keep safely for future reference.

There is an instruction compartment in the back of the child car seat for storage of the instruction manual.



! CAUTION

DO NOT use the child seat forward facing when your child is below 9kg.

! CAUTION

Never use the child car seat without its fabric cover because the fabric cover constitutes as an integral part of the child car seat performance. The fabric cover should not be replaced with any other than the ones recommended by manufacturer.

! For the protection of your baby

! CAUTION

Please use the baby insert attached to this car seat when your baby's weight is less than 15kg.

The baby insert is used to provide extra comfort for very small babies, and it gives your baby the necessary support while he or she is still small.

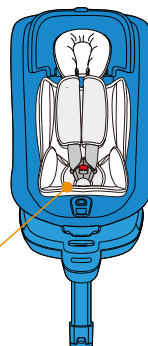

Baby Insert

- Always secure your baby in the car seat using the harness.
- Never leave your baby unattended in the car seat when placing it on elevated surfaces (e.g. a table, nappy changing unit, etc.).
- Never allow the strap end to become caught in moving parts (e.g. automatic doors, escalators, etc.).
- **Caution!** The plastic parts of the car seat heat up in the sun so your baby may get burnt. Protect your baby and the car seat against intensive solar radiation (e.g. by putting a light cloth over the seat or using a sunshade on the window).
- Take your baby out of the car seat as often as possible to relieve its spine. We recommend frequent breaks during long journeys. Even outside of the car, please avoid leaving your baby in the car seat for too long.

5 Installation in the vehicle

Fitting & Operation Information

5.1 Preparatory

Warning: Ensure that your vehicle has ISOFIX anchor points.

Unfold support leg until it locks in place,
Unfold ISOFIX arms by squeezing the ISOFIX release button and pull the ISOFIX retract loop.

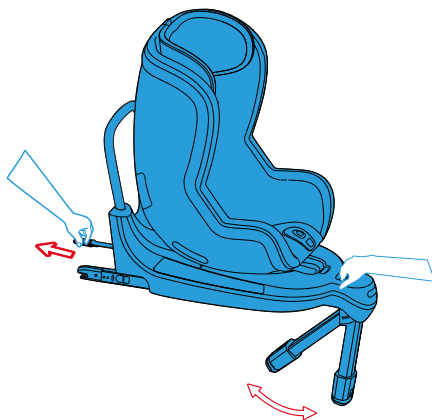

5.2 Fitting

Place the child seat over the vehicle seat, engage the ISOFIX and ensure the green ISOFIX indicators must now be visible on both sides.

Push the adjustment button and pull out the support leg until it rests firmly on the floor.

The support leg indicator must be completely green.

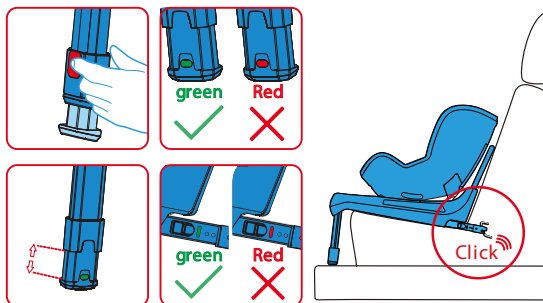

5 Installation in the vehicle

5.3 Removing child car seat

Push the support leg button, slide the lower section of the support leg into the upper section until it is fully stored.

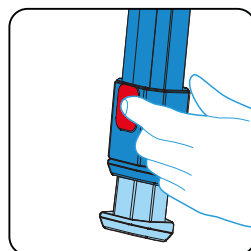

1

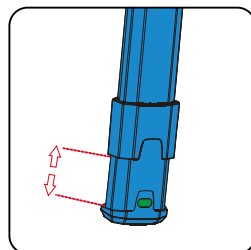

2

5.4 Removing child car seat

Push the green ISOFIX indicator and the red release button on the two locking arms toward each other.

The locking arms released Pull the ISOFIX release button and slide the ISOFIX locking arms back into the seat shell.

You may hear a rattling noise this is normal when the locking arms are pushed back in.

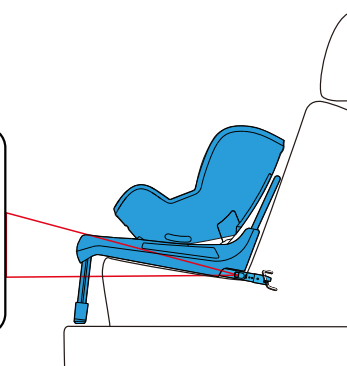

6 Securing your child

6.1 Headrest adjust

There are seven adjustable headrest position, pull the headrest adjust button upwards, move the headrest to the correct shoulder strap height and check that it is properly engaged by lightly sliding the head rest downwards.

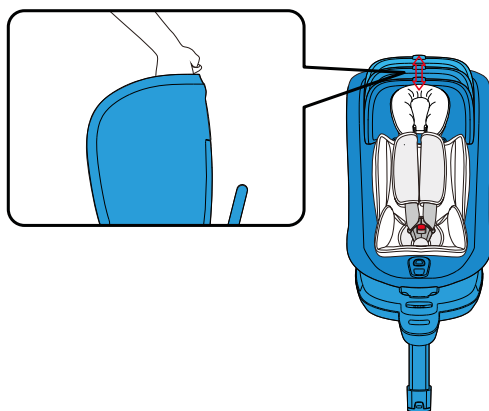

6.2 To change the recline

The seat can be reclined into multiple different positions.

You can change the recline position while the child is installed in the car seat.

Changing the recline position gives your child optimal comfort for sleeping.

For younger children from 0-6 months, use the seat in its most reclined position with the infant insert to ensure your child's spine is supported whilst sleeping.

To change the positions, grasp the recline button and push or pull the seat into the desired position.

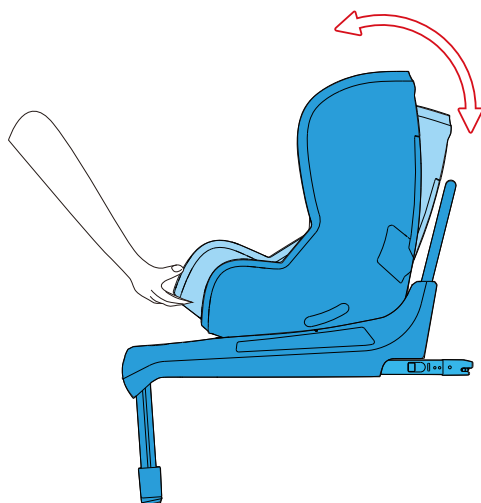

6 Securing your child

6.3 Swiveling Function

The 360° seat rotation which makes it easier to get your child into or out of the child seat. The seat can rotate by pressing the rotation button and turn the seat into the direction of travel.

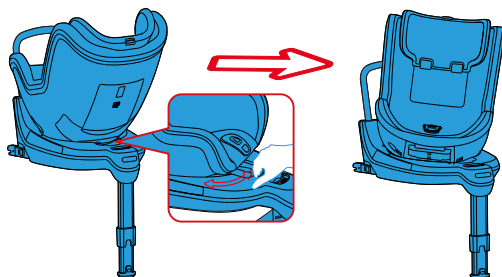

CAUTION

Before every journey: make sure that the rotation part of the child seat is fully engaged by trying to turn the seat around in both directions.

Do not drive unless car seat is front or rear facing direction.

6.4 Forward facing from 9-18kg

If you want to use the child seat in Group 1 (9-18kg), press the rotation button and turn the seat in the direction of travel.

CAUTION

DO NOT use the child seat forward facing when your child is below 9 kg.

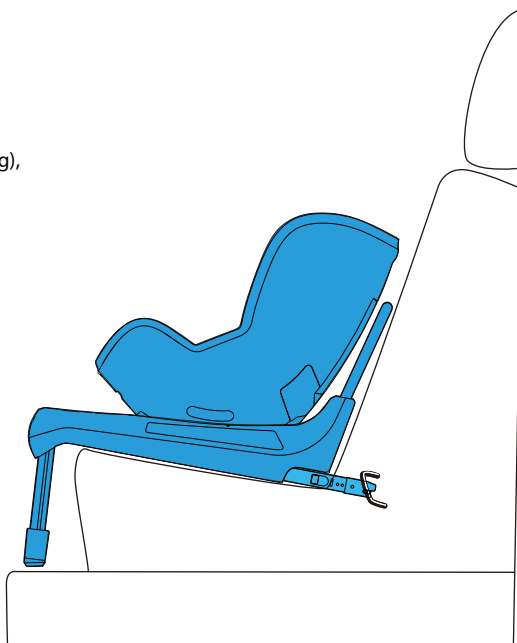

6 Securing your child

6.5 Rearward facing from 0-18kg

If you want to use the child seat in group 0+ (0-18kg), press the rotation button and turn the seat against the direction of travel, now the child set is in the mode for Group 0+ (0-18kg) rearward facing. Grasp the recline button and press the child seat into the most reclined position .

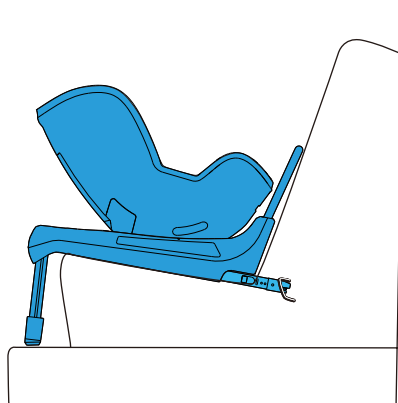

Do not use on passenger seats with a front airbag!

6.6 Loosening the harness system

Pull the shoulder strap up as shown in the picture while pressing the button of the central adjuster.

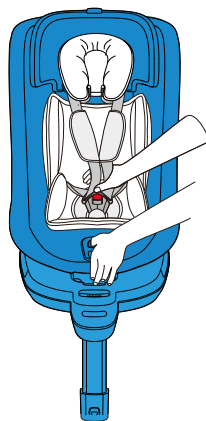

Open the harness buckle and position the shoulder straps at the sides of the seat to keep the harness open while positioning the child.

The harnesses can be held open with supports on either side of seat.

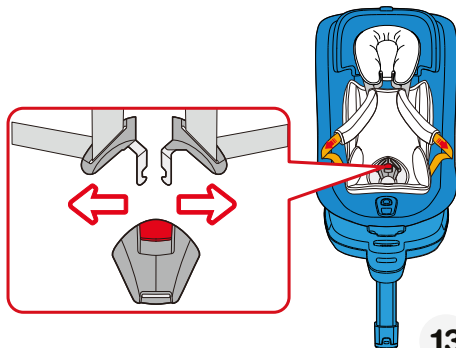

6 Securing your child

Separate the harness and have your child sit down in the child seat.

Guide the two buckle latches together and engage them before putting them into the harness buckle, this should make a clicking sound. The harness must be reasonably tight.

It should restrain but not make the child uncomfortable.

Pull on the adjustment strap until the harness lies flat and is close against your child's body.

NOTE: The straps should be correctly adjusted and ensure they are not twisted.

IMPORTANT

Please note a correctly adjust headrest ensures optimal protection for your child in the safety seat; the headrest must be adjusted so that the, shoulder straps are at the same level as your child's shoulders or slightly above. The shoulder straps must run at shoulder height or a little above the height of the child's shoulders.

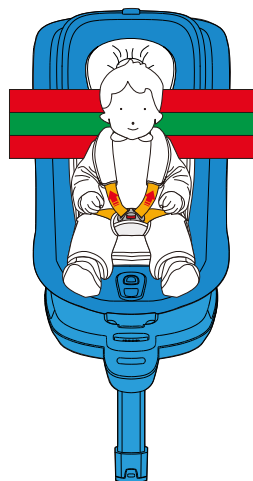
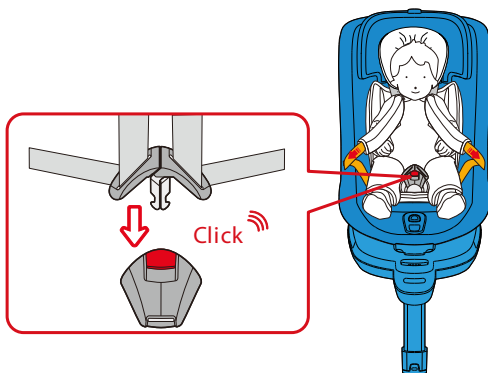

6.7 Cuddleme system

The cuddleme baby insert gives your baby the necessary support while he or she is small.

- The child safety seat must be used with the cuddleme baby insert until your baby has reached a body weight of 13 kg.
- The cuddleme baby insert must never be used without its foam part for babies weighing under 5.5 kg.
- Only use the cuddleme baby insert when the shoulder strap is in the lowest position.

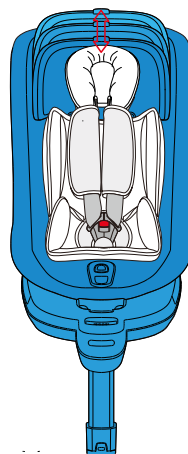

6 Securing your child

The cuddleme baby insert with foam part is unsuitable for children over 13 kg. In this case, you must remove the cuddleme baby insert or only the foam part from the child seat.

Tip! The cuddleme baby insert can also be used without foam part for children over 13 kg.

Remove the foam part from the net pocket on the back of the cuddleme baby insert.

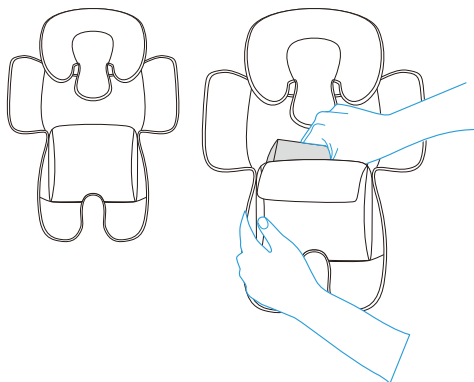

7 Checklist

For safety's sake read through this checklist before you set off. Check that the harness belt system fits properly and lightly around your child and that the shoulder belts are at the correct height.

Check regularly that the baby car seat is not damaged. If it is damaged do not use your product in any circumstances and contact your supplier or retailer.

If you have any questions, please contact your supplier.

Make sure that you have the following details to hand:

- Serial number.
- Mark and type of vehicle and seat on which the baby car seat used.
- Age and weight of your child.

8 Cleaning

Please be sure to use only original seat covers, as the seat cover is important to the proper functioning of the system. Replacement seat covers are available from your retailer.



The child seat must not be used without the seat cover

- The cover can be removed and washed with a mild detergent using the washing machine for delicate items (30°C). Please observe the instructions on the washing label of the cover. The colour of the cover may fade if washed at more than 30°C. Do not spin, and never tumble dry in an electric clothes dryer (the fabric may separate from the padding). Please be sure to use only original seat covers, as the seat cover is important to the proper functioning of the system. Replacement seat covers are available from your retailer.
- The plastic parts can be cleaned using soapy water.
- Do not use harsh cleaning agents (such as solvents).
- The harness can be removed and washed in lukewarm soapy water.

Caution! Never remove the buckle tongues from the straps.

9 Warranty

The warranty period starts from the date of purchase and is valid for a period of 12 months.

The warranty is only applicable to the original owner and is not transferable. The warranty is only applicable to products that have not been adapted by the user.

In the case of any defects, the owner is required to return the product to the retailer.

Repairs do not constitute an extension to the warranty term.

The manufacturer is not liable for any damages other than those on products supplied.

No warranty given if:

- The product is not supplied complete with the validated purchase receipt to the manufacturer.
- Defects are caused by misuse or maintenance which differ from that indicated in the instruction manual.
- Repairs are carried out by third parties.
- Defects are caused by neglect.
- Damage or removal of any serial number is found.
- If there is normal wear and tear which may be expected from everyday use.
- The stated warranty terms and conditions have not been satisfied.

MyBabiie®

For little people who dream big

Register your product at:

www.mybabiie.com/warranties

In the first instance of needing assistance please contact your original place of purchase.

This product qualifies for 12 month warranty when registered through our site

Follow us!



/MyBabiie



@MyBabiieOfficial



@MyBabiie



/MyBabiie

My Babiie. Part of My Companiie Ltd
Repton Manor, Repton Avenue, Ashford, Kent, TN23 3GP