

# MyBabiie®

For little people who dream big

**Register your product at:**

[www.mybabiie.com/warranties](http://www.mybabiie.com/warranties)

**In the first instance of needing assistance please  
contact your original place of purchase.**

This product qualifies for 12 month warranty when  
registered through our site

## Follow us!



/MyBabiie



@MyBabiieOfficial @MyBabiie



/MyBabiie

My Babiie. Part of My Companiie Ltd  
Repton Manor, Repton Avenue, Ashford, Kent, TN23 3GP

# MyBabiie®

For little people who dream big

## Group 0+ Car Seat (0-13 kg) Instructions

### GB Instruction Manual

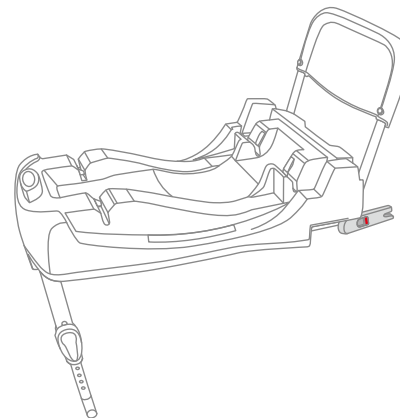

The product has been approved according to the strictest European  
safety standards (ECE R 44/04) and is suitable for Group 0+ (0-13 KG).

**IMPORTANT! KEEP FOR FUTURE REFERENCE**

# **IMPORTANT:** **KEEP THESE INSTRUCTIONS FOR** **FUTURE REFERENCE**

**Read these instructions carefully.**  
**Your child's safety may be affected if**  
**you do not follow these instructions**

## **USER GUIDE**

---

Thank you for choosing our product. Please take a little time to read the important safety notes detailed below. This will ensure many years of happy, safe use.

## **SAFETY: TAKE NOTE**

---

### **WARNING: A CHILDS SAFETY IS YOUR RESPONSIBILITY**

- When fitted with the My Babiie car seat, this combination has been approved for mass group 0+ which is suitable for transportation in cars of children from birth up to 13kg (approximately 15 months old).

**WARNING:** After an accident the child car seat & base should be replaced.

**WARNING: NEVER** use this child car seat base on a side facing vehicle seat.

**WARNING: NEVER** use this child car seat base on a passenger seat fitted with an active airbag.

**WARNING:** **NEVER** leave your child unattended, even for the shortest time.

**WARNING: ALWAYS** secure your child with the safety harness when using the child car seat.

**WARNING: DO NOT** attempt to dismantle, modify or add to any part of the child car seat or change the way your vehicle seat belts are made or used.

**WARNING:** Any rigid items and plastic parts of the child car seat must be so located and installed that they are not liable, during everyday use of the vehicle, to become trapped by a movable seat or in a door of vehicle.

**WARNING:** If any load bearing points other than those described in the instructions are used, this can significantly reduce the protection factor of the child car seat.

- The child car seat must always be placed in a rearward facing position.

- The child car seat base must always be placed and secured with the support leg in front.
- Always make sure that the child car seat harness is correctly tensioned to ensure maximum protection for your child.
- The child car seat buckle has been designed to be released quickly in an emergency. IT IS NOT CHILD PROOF. More inquisitive children might learn to undo the buckle. Children should be told never to play with it or any other part of the child car seat.
- Never use any replacement parts other than those that are approved by My Babiie.
- Safely secure any luggage and other objects that might cause injury to the occupant of the child car seat & base in the event of a crash.
- Do not place anything such as a towel or cushion under the child car seat base. This could affect the performance of the child car seat base in an accident.
- Do not place any objects in the foot well in front of the child car seat base.
- My Babiie advise that child car seats or base should not be brought or sold second-hand. Many seats sold through local advertising and car-boot sales have been found to be dangerous.
- Cover the child car seat base if it is left in direct sun light for prolonged period as the child car seat base surfaces may get very hot. Check the child car seat base surface before placing your child in the seat.
- Security is only guaranteed if the child car seat base is fitted in accordance with these instructions.
- Do not allow children to play with or adjust the car seat base.
- Failure to comply with the above instructions will automatically void the warranty and exempt My Babiie from any liability.
- **NOTE: The car seat base can mark vehicle seat upholstery.**  
**My Babiie cannot be held responsible for damage or marking to vehicle seat upholstery.**

## NOTICE:

---

1. This is an ISOFIX CHILD RESTRAINT SYSTEM. It is approved to Regulation No. 44, 04 series of amendments for general use in vehicles fitted with ISOFIX anchorages systems.
2. It will fit vehicles with positions approved as ISOFIX positions (as detailed in the vehicle handbook), depending on the category of the child seat and of the fixture.  
We recommend customer to check compatibility of the child restraint with the intended vehicle prior to fitting. The compatibility list can be found on the back of the instruction manual.
3. When fitted with the car seat, the mass group and the ISOFIX size class for which this device is intended is: Group 0+ (0 – 13kg), Class C.
4. Never use this child car seat on passenger seat fitted with active airbag.
5. If in doubt, consult either the child restraint manufacturer or retailer.

## CARE

---

Your child car seat base has been designed to meet safety standards and with correct use and maintenance will give many years of trouble free performance.

Storing a damp child car seat base will encourage mildew to form.

After exposure to damp conditions, dry off with a soft cloth and allow to dry thoroughly before storing.

Store your child car seat base in a dry, safe place.

Leaving the child car seat in sunlight for prolonged periods may cause fabrics to fade.

## MAINTENANCE

---

Inspect the child car seat base regularly for signs of damage. Stop using the product if any of the component have become damaged.

When fitted to vehicle seat, check the fitting child car seat base regularly to ensure the fitting is secured and the child car seat harness are not obstructed or twisted.

DO NOT take apart, or attempt to take apart the car seat base when cleaning. It is unnecessary and dangerous to do so.

## CLEANING

---

Plastic and metal parts may be sponged clean with warm water and a mild detergent.

Never clean with abrasive, ammonia based, bleach based or spirit type cleaners.

## OPERATION

---

### 1. GETTING TO KNOW YOUR CHILD CAR SEAT BASE

- 1 Child car seat base
- 2 Anti rebound bar
- 3 Release button
- 4 Front support leg
- 5 Child car seat locks
- 6 ISOFIX locking arms
- 7 ISOFIX connection indicator
- 8 ISOFIX guides

### 2. PREPARING THE CHILD CAR SEAT BASE FOR FITTING

Turn the child car seat base over.

Unfold the Anti rebound bar (a).

Unfold the two ISOFIX locking arms (b).

Unfold the front support leg until it locks in place (c).

### 3. FITTING THE ISOFIX GUIDES

**WARNING:** Ensure that your vehicle has ISOFIX anchor points.

Refer to the vehicle list in these instructions for information of where the child car seat base will fit in your vehicle.

Locate the vehicle ISOFIX anchor points. They are usually located between the vehicle seat base and back. If in doubt, please consult the vehicle handbook.

Insert the two plastic ISOFIX guides and hook them onto the vehicle ISOFIX anchor points (a). The plastic guides can help identify the vehicle ISOFIX anchor points and make installation easier. They can also help with the protection of your vehicle seat.

### 4. FITTING THE CHILD CAR SEAT BASE TO THE VEHICLE SEAT

Place the child car seat base on to the vehicle seat.

Align the ISOFIX locking arms with the ISOFIX guides. Push the child car seat base back (a) until a 'click' is heard from each locking arm.

If the locking arms are located correctly the colour of ISOFIX connection indicators on the side of the locking arms will have turned to green (b).

Pull the child car seat base back slightly to check it's securely attached to the vehicle seat.

#### 5. EXTENDING THE FRONT SUPPORT LEG

Squeeze the front support leg adjuster button (a) and raise (b) or lower (c) the front support leg so that it makes firm contact with the vehicle floor.

Release the adjuster button when the front support leg is in the correct position.

Pull the foot of the front support leg downwards until it locks in position.

**WARNING:** Do not place the front support leg on a floor storage compartment lid. The front support leg **MUST** make full and firm contact with the vehicle floor (d).

**WARNING:** Make sure that the front support leg does not raise the base from the surface of the vehicle seat.

#### 6. FITTING THE CHILD CAR SEAT TO THE CHILD CAR SEAT BASE

With the child car seat handle in the carrying position place the child car seat, rearward facing, on the child car seat base.

Push the child car seat until the securing rods are engaged and a 'click' is heard from each lock.

Lift the child car seat to ensure that all locks are fully engaged.

Note: If the child car seat is fitted correctly the yellow strips (a) on the top surface of the child car seat base should be hidden by the child car seat (b).

#### 7. REMOVING THE CHILD CAR SEAT TO THE CHILD CAR SEAT BASE

Press the release button (a) and simultaneously then lift the child car seat off the child car seat base (b).

#### 8. REMOVING THE CHILD CAR SEAT BASE FROM THE VEHICLE SEAT

Pull the release buttons back on the ISOFIX locking arms (a) and then pull the child car base out of the ISOFIX guides (b).

The child car seat base can now be removed from the vehicle seat

#### VEHICLE FITTING LIST

This child Restraint is classified for Semi-universal use and is suitable for fixing into the seat positions of the following cars:

01

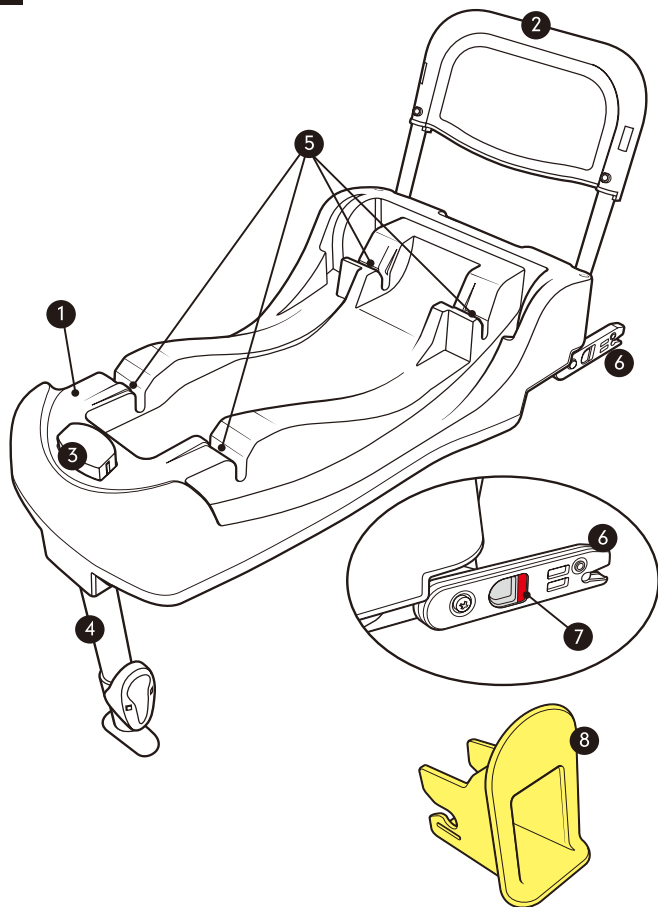

02

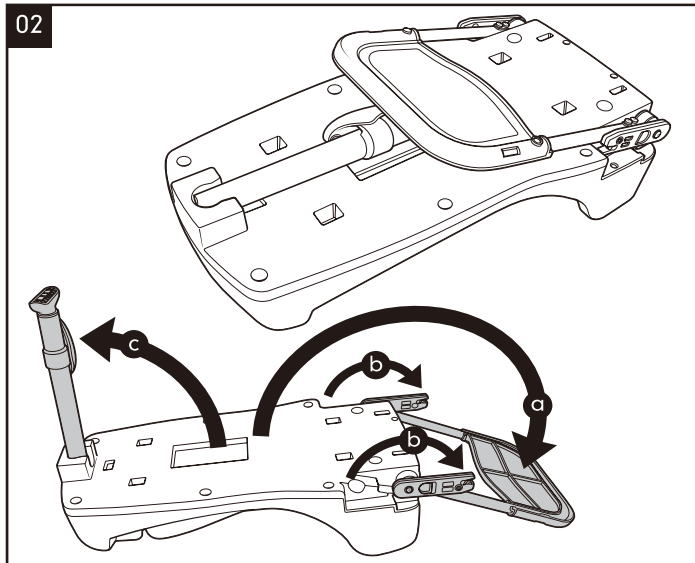

03

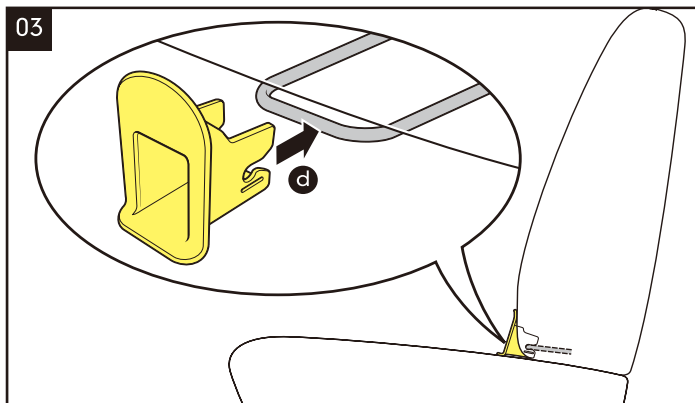

04

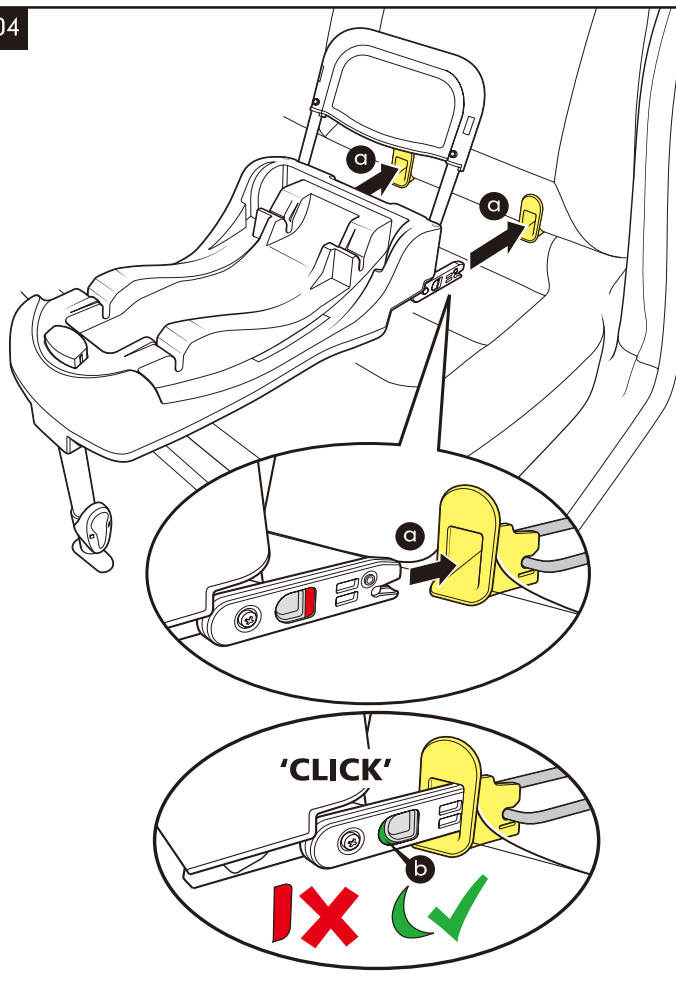

05

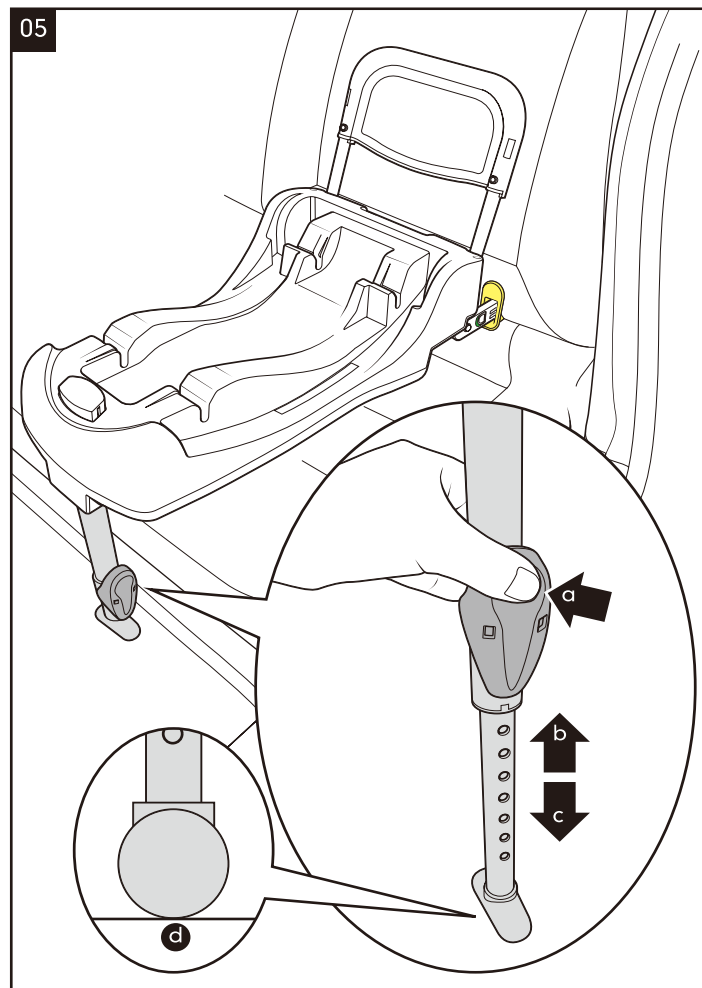

06

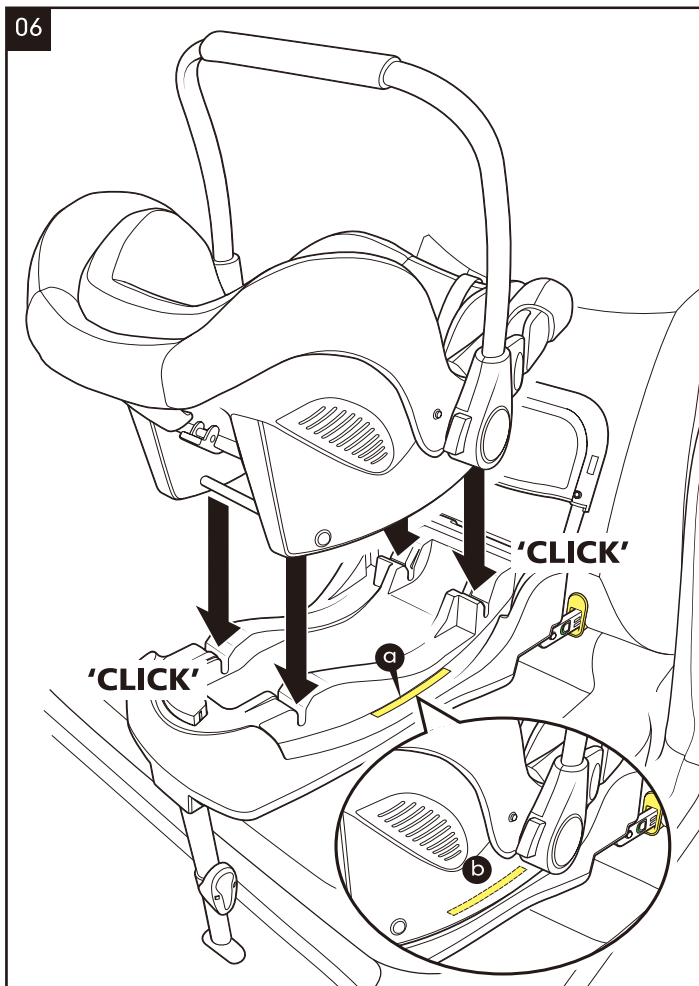

07

